

BAYVIEW PAVILION CLASS A OFFICE BUILDING FOR SALE



15550 Lightwave Drive, Clearwater, Florida

- Building is 100% Leased to "A" Rated Credit Tenants.
- Located at the highly visible intersection of Roosevelt Blvd & 49th St North & has immediate access to the south entrance of Bayside Bridge.
- Adjacent to the St. Petersburg / Clearwater International Airport.
- Offers large Parking Garage + Surface Parking which provide 4.85 parking spaces per 1000 RSF leased.
- Has efficient 32,000 RSF floor plates w/ 10'-14' ceilings which offer Great views of Tampa Bay !
- Three (3) story glass Entrance Lobby with marble floor Offers Building tenants 24 Hour Building access & security via a computerized card entry system.

**All bids must be submitted
no later than Friday, May
31, 2013**

For More Information Please Contact:

Michael S. Talmadge
mtalmadge@echelonre.com
www.eresproperties.com
727.214.4650



235 Third Street S, Suite 300
St. Petersburg, FL 33701

BAYVIEW PAVILION CLASS A OFFICE BUILDING FOR SALE

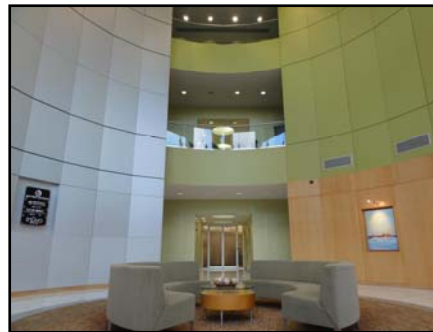

Bayview Pavilion is located south of Clearwater's Bayside Bridge and provides easy access to the Tampa Bay area through U.S. Highway 19, 49th Street, and Interstate 275.

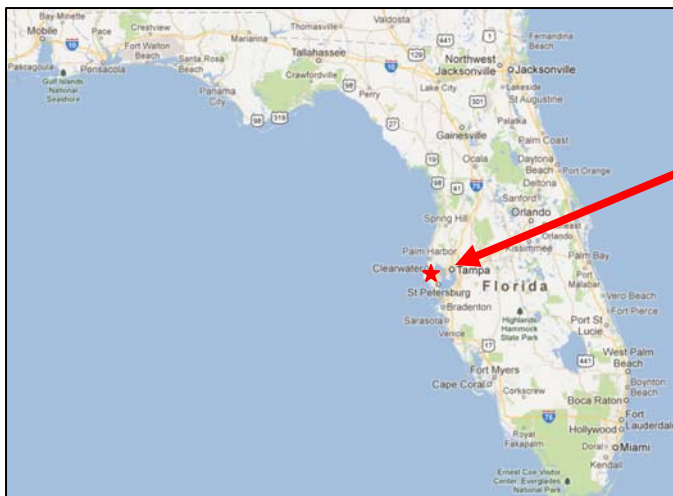

Licensed Real Estate Broker
235 Third Street S, Suite 300
St. Petersburg, FL 33701

MICHAEL S. TALMADGE
Echelon Real Estate Services, LLC
mtalmadge@echelonre.com
727.214.4650

www.eresproperties.com