

# WaterView at Echelon City Center

**CARILLON PARK – 226 Residences**  
**ST. PETERSBURG, FLORIDA**

**CLASS A RETAIL STORE FRONT**  
**1,000 RSF to 5,000 RSF AVAILABLE**



## NEW RETAIL SPACE FOR LEASE:

- 1,000 to 5,000 RSF of Retail Space Available.
- \$40.00 NNN + CAM.
- Lease Term: 10 years +
- Surface + Covered Parking with immediate proximity to WaterView.
- Built to latest Miami/Dade County Windstorm + Flood Construction Standards.
- In 2026, Echelon City Center will support approx. 1,000 units within a 2-block radius of the ECC Retail users.

## CARILLON PARK STATISTICS:

- Ulmerton Road AADT 2 Way: 83,000 cars/day
- 2200 In-Park Residents
- 14,000 Daytime Employees
- Direct Access to Ulmerton Rd + I-275

**FOR MORE INFORMATION, PLEASE CONTACT:**

**MICHAEL S. TALMADGE**

**727.214.4650**

**mtalmadge@echelonre.com**

**ECHELON**

Echelon Real Estate Services, LLC  
Licensed Real Estate Broker



# WaterView at Echelon City Center

CARILLON PARK – 226 Residences  
ST. PETERSBURG, FLORIDA

CLASS A RETAIL STORE FRONT  
1,000 RSF to 5,000 RSF AVAILABLE

Space is also Available for Non-Restaurant Tenants

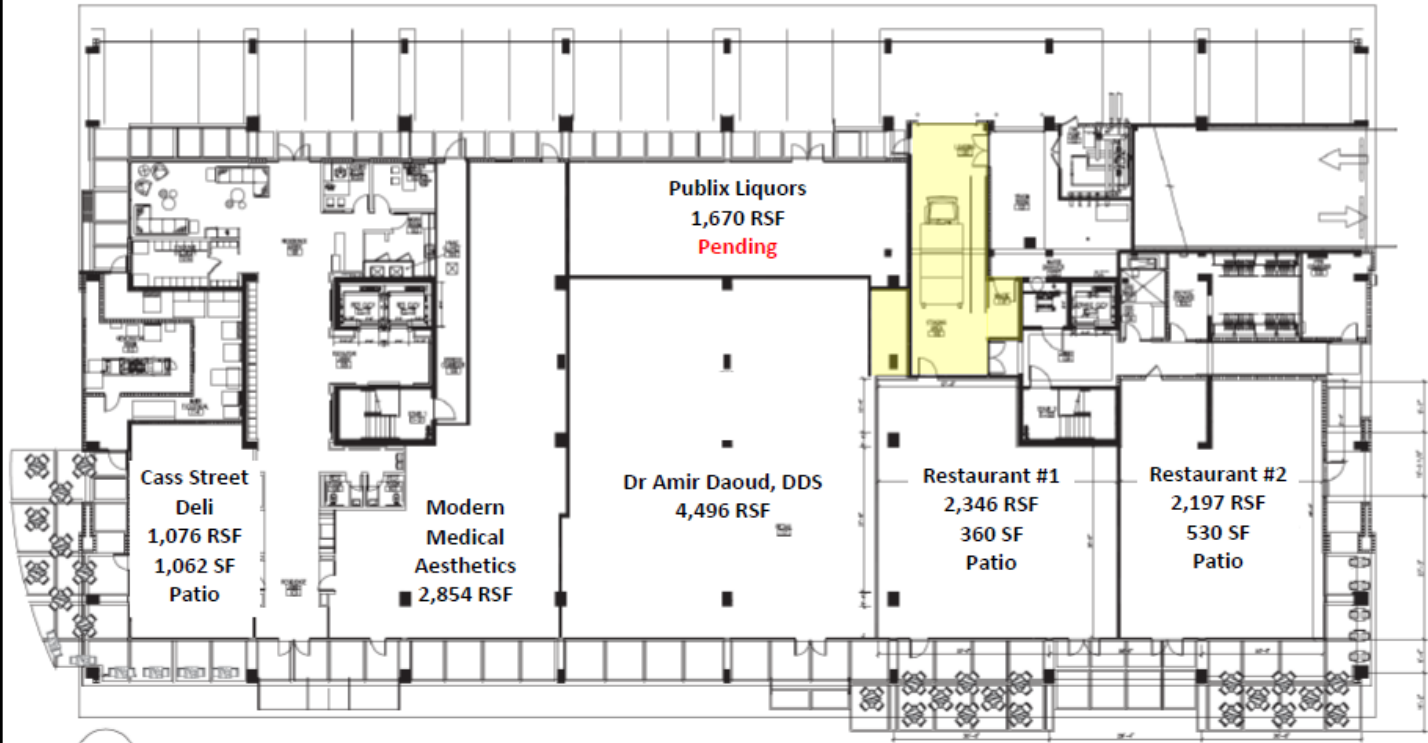

## STOREFRONT RETAIL SPACE

FOR MORE INFORMATION, PLEASE CONTACT:

MICHAEL S. TALMADGE

727.214.4650

mtalmadge@echelonre.com

ECHELON

Echelon Real Estate Services, LLC  
Licensed Real Estate Broker





# WaterView at Echelon City Center

CARILLON PARK – 226 Residences  
ST. PETERSBURG, FLORIDA

CLASS A RETAIL STORE FRONT  
1,000 RSF to 5,000 RSF AVAILABLE

